

Samsung QB/QH/QM 32 - 43" Portrait Adapter Plate

Item no.: 2289

Display specific adapter plate

The Samsung QB, QH and QM series include displays for professional use. The VESA standard of the devices is optimized for an installation in landscape format, which means that it is not centralized.

This is where the SAMSUNG QB/QH/QM 32 - 43" Portrait Adapter Plate provides a remedy.

Conditioned by the decentralized VESA hole pattern, the screens can easily be mounted in a centralized portrait format.

The VESA standard 100 x 100 mm or Hagor's own 125 mm hole pattern are used for an installation on the mounting system. The VESA 200 x 200 mm hole pattern is available for mounting the screen.

Due to the ultra-flat design and the low depth of only 3 mm, the adapter plate can be used almost anywhere without any problems.

It can be used with selected wall mounts, ceiling mounts or stand systems with VESA standard 100 x 100 mm or Hagor's own 125 mm hole pattern.

The surface of the adapter plate is finished with an impact- and scratch-resistant powder coating in black.

All fastening materials for screwing to the TV mount are included.

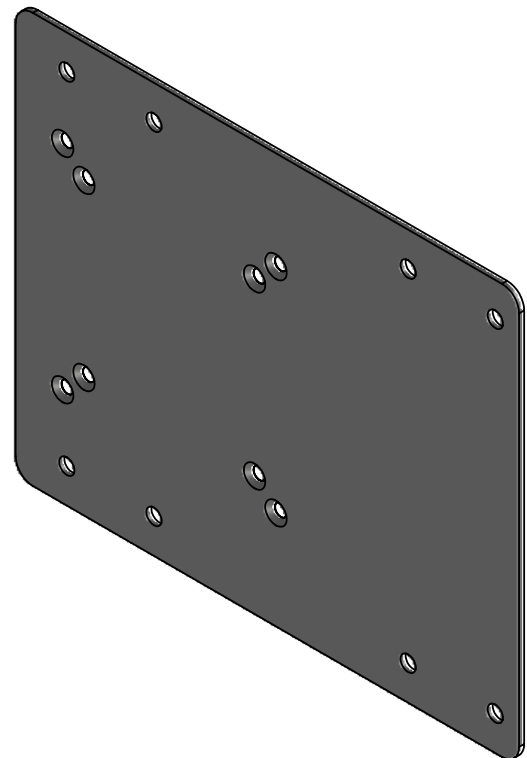
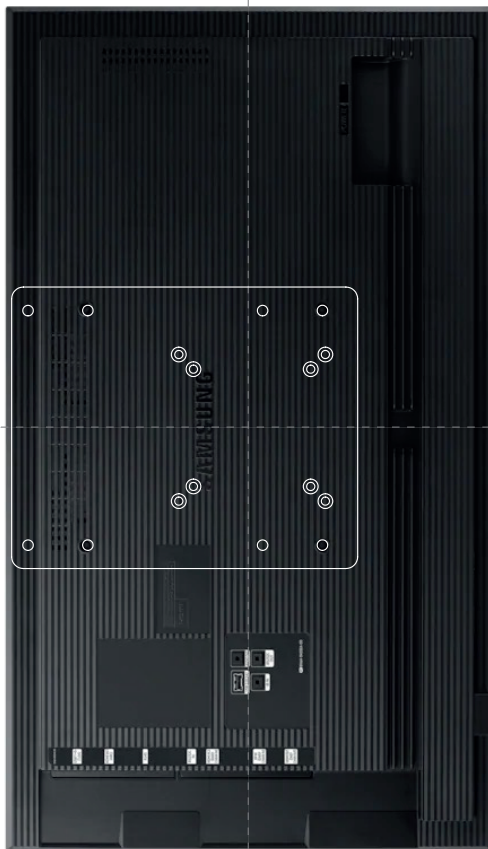

the decentralized arrangement of the VESA hole pattern is completely compensated by the adapter plate

Samsung QB/QH/QM 32 - 43" Portrait Adapter Plate

Item no.: 2289

Display specific adapter plate

- display specific adapter plate
- suitable for Samsung QB, QH and QM series with 32 - 43" | 81 - 109 cm
- allows a centralized alignment of the screen when mounted in portrait format
- VESA 200 x 200 mm for mounting the screen
- VESA 100 x 100 mm or Hagor's own 125 mm hole pattern for installation on the mounting system
- dimensions: width 295 x height 240 x depth 3 mm
- impact- and scratch-resistant powder coating
- colour: black
- incl. all fastening materials

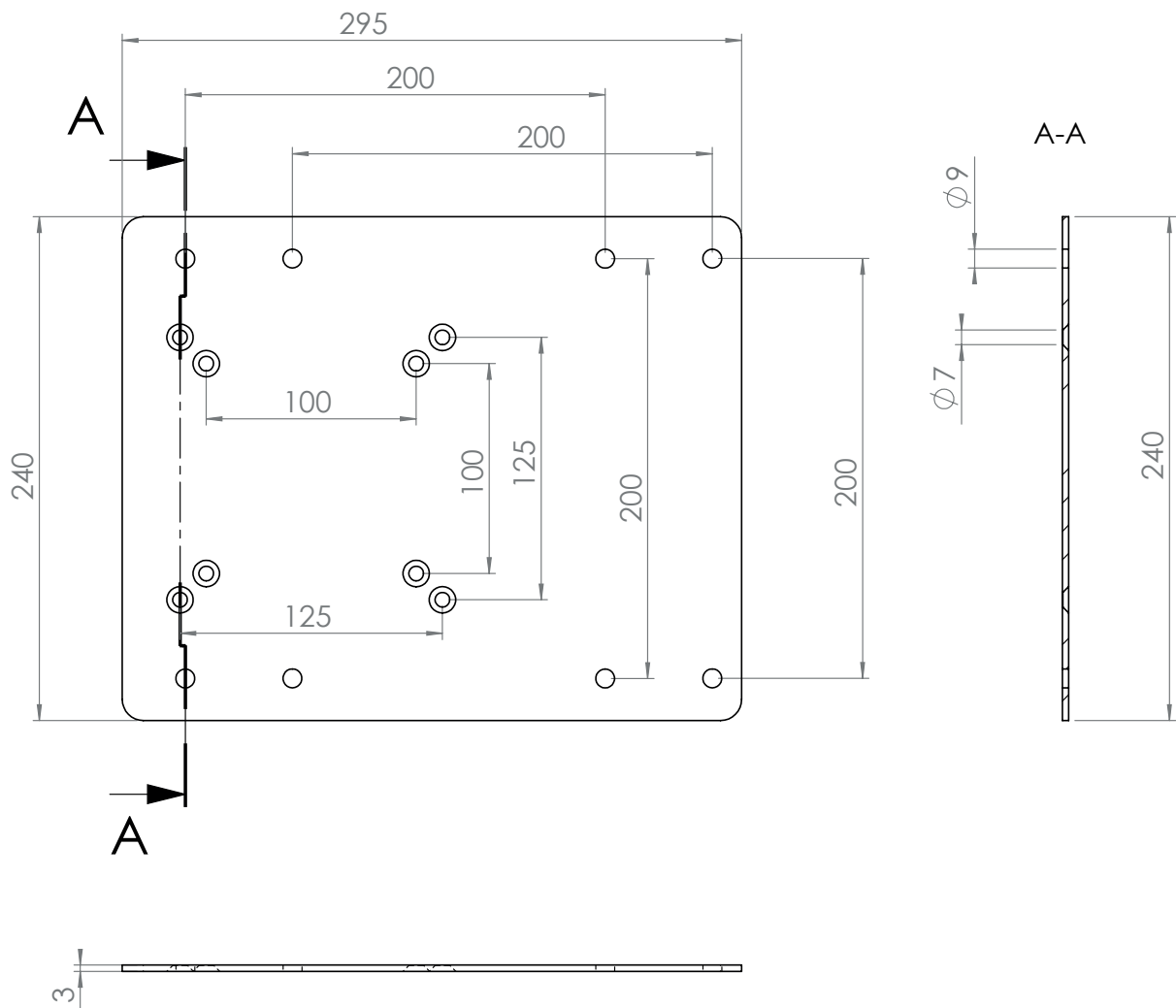

Technical changes reserved